

Innovations for etics, plastering and dry-lining



# INNOVATIONS FOR PLASTERING, DRYWALL & ETICS

Quality, precision, and sustainability:  
Our profiles set standards.



Your partner  
for innovative  
& sustainable  
solutions



[www.vws.de](http://www.vws.de)

An aerial photograph of a city, likely Berlin, with a semi-transparent globe overlaid on the right side. The globe shows the city's location on the European continent. The city's grid and buildings are visible, and the overall tone is bright and clean.

Dear customers and interested parties,

As the management of VWS, we are pleased to provide you with an insight into our company philosophy and our products.

Quality, precision, and sustainability are values that drive our company.

Innovation is the basis of our success. We take pride in our ability to advance technological progress and creative solutions. We tirelessly work on developing new products and improving existing ones.

It is particularly worth mentioning our focus on the sustainability of our products and production processes. We commit to ethical, social, and environmentally friendly standards and contribute to protecting the world for future generations.

Our goal is to manufacture high-quality products while providing excellent customer service. Customer satisfaction is the benchmark for our actions.

We sincerely thank you for your interest and support. Your feedback and suggestions are of crucial importance to us.

Kind regards,

A handwritten signature in blue ink that reads "Karl-Helmut Vollmer".

Karl-Helmut Vollmer  
Managing Partner  
VWS Befestigungstechnik

A handwritten signature in blue ink that reads "Christian Achilles".

Christian Achilles  
Executive Management  
VWS Befestigungstechnik



# CONTENT

04	ABOUT VWS
05	OUR COMMITMENT
06	SUSTAINABILITY
07	QUALITY
08	RESEARCH & DEVELOPMENT
09	PRODUCT INNOVATION
12	CUSTOMER SUPPORT
13	THE "VWS CAMPUS"
14	LOGISTICS
15	SOCIAL RESPONSIBILITY
16	OUR PROFILES

# ABOUT VWS

Since 1981, VWS, a medium-sized enterprise, has been synonymous with innovations in plastering, drywall, and external thermal insulation composite systems (ETICS). As part of the Vollmer Group, we place great emphasis on sustainability. Our long-standing expertise and technical competence make us a reliable partner.



# > 40

Years of experience in the development and production of profiles

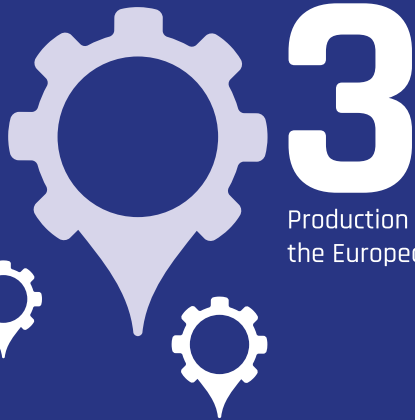

# 3

Production sites in the European Union



# > 100

Employees in the European Union



# > 500

Various products in over 1200 variants



# 1700

Satisfied customers worldwide



# 60 Mio.

Meters of profiles sold in 2023



# OUR COMMITMENT



## 1. Sustainability

We are committed to sustainability, for instance, by employing environmentally friendly production practices and using sustainable materials.

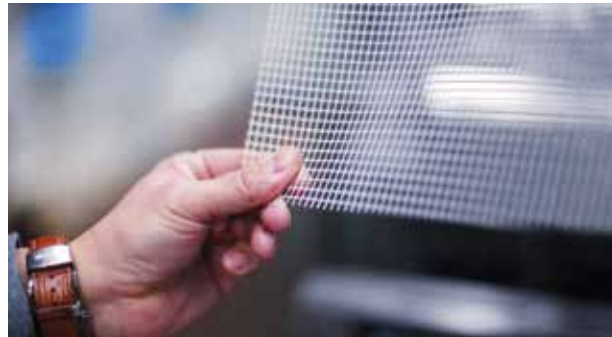

## 2. Quality

Quality is the top priority at VWS. Our products are subject to strict quality controls to ensure the highest standards.



## 3. Research & development

With cutting-edge technologies and innovative materials research, we develop new products and solutions for our customers.



## 4. Customer support

VWS is characterized by competent care and comprehensive support. The "VWS Campus" offers numerous product training sessions by experts.



## 5. Logistics

Through efficient logistics and the optimization of our processes, we ensure on time deliveries with minimal costs and emissions.



## 6. Social responsibility

The Diversity Charter is our guide for an inclusive and diverse working environment. We actively advocate for diversity and equal opportunities.

# SUSTAINABILITY



## The promotion of sustainability in construction aligns with the goals of the Vollmer Group

The Vollmer Group is intensifying its commitment to sustainability. This is demonstrated by setting cross-company objectives and by making significant investments in biomass and solar parks.

VWS makes a contribution to achieving these goals. We bear responsibility for the environment and our fellow human beings. We therefore strive to make our products more environmentally friendly and durable.



### Recycling

100% of the production waste is added to the production cycle.



### >30% Regranulate

Our products consist of over 30% regranulate.



### 100% Green electricity

We produce exclusively with green electricity.



### 100% Adhesive paper tape

We only use sustainable paper adhesive tapes.



### Sustainable materials

We rely on resource-conserving materials such as recycled raw materials.



### Declarations

We create EPDs (Environmental Product Declarations) for our profiles.



### Ecovadis-rating

This year, our production facility in France received the bronze rating from Ecovadis.



### UN Global Compact

We are committed to ethical, social and environmental standards, for example through our participation in the UN Global Compact.

# QUALITY



Permanent internal  
production controls



Products externally tested  
(ift Rosenheim)



ISO 9001 certification  
since 1996



Use of high-quality and  
ecological materials

“ At VWS we want to develop products of outstanding quality that meet the highest standards. ”

Christian Achilles, VWS Management Board

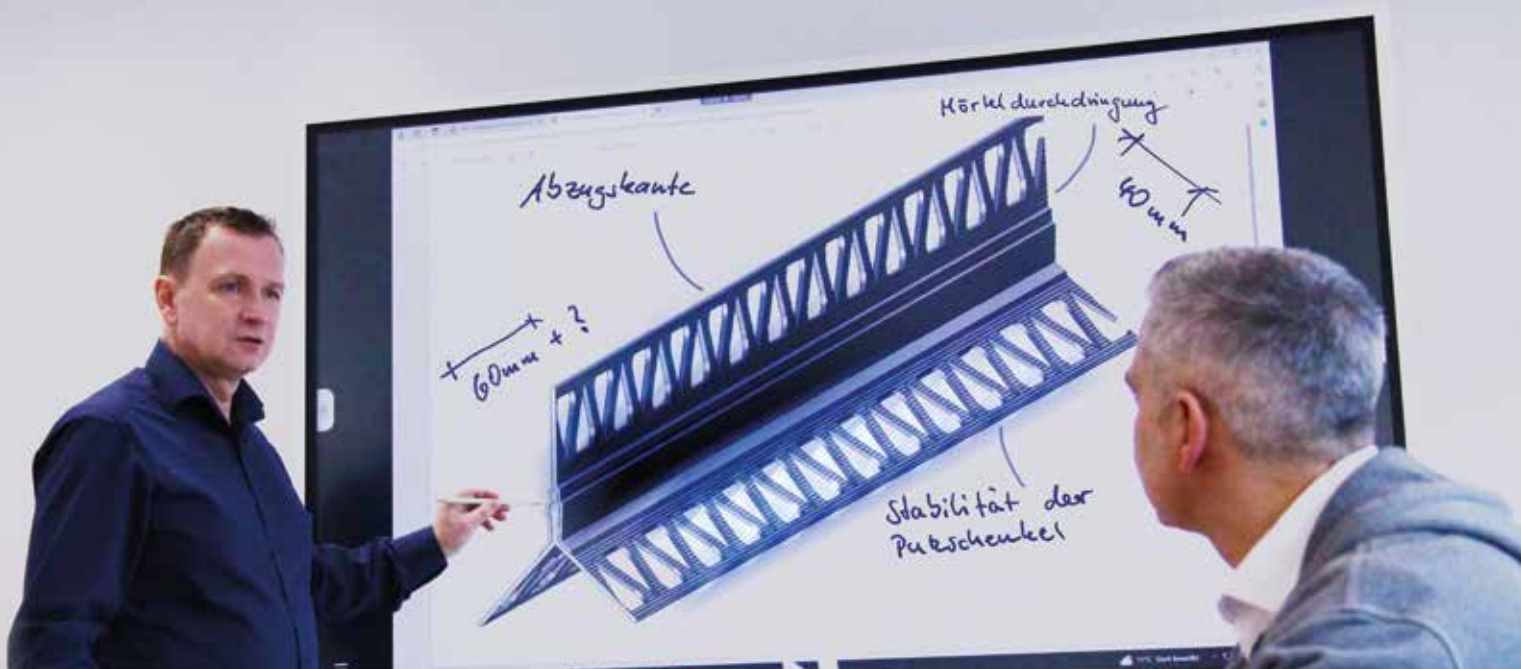

# RESEARCH & DEVELOPMENT



## Own department for research & development

Our research and development department utilizes cutting-edge technologies to explore new and eco-friendly materials for product development. Additionally, we prioritize automation and continuously strive to enhance our products.



## Product development with our customers

The needs and feedback of our customers are paramount in our product development process. They inspire new ideas and motivate us to create products that surpass expectations.



## The latest technical standards and continuous improvements

At VWS, we focus on technical standards and peak performance. Through stringent quality controls and streamlined processes, we continuously improve our products, delivering top-tier solutions for plaster, dry construction, and ETICS (External Thermal Insulation Composite Systems).





# INVESTMENT IN OUR PRODUCTION

**By replacing our punching tools with significantly more efficient rotary tools, we have not only achieved significant energy savings but also notably reduced noise in production. Profiles can now be identified by the “V” pattern in the perforation.**

**In addition to the production of metal profiles, we also offer the entire range of mesh groove profiles and molded parts. Our customers particularly appreciate the flexibility of our systems, which enable us to meet a wide range of customer requirements for special profiles.**

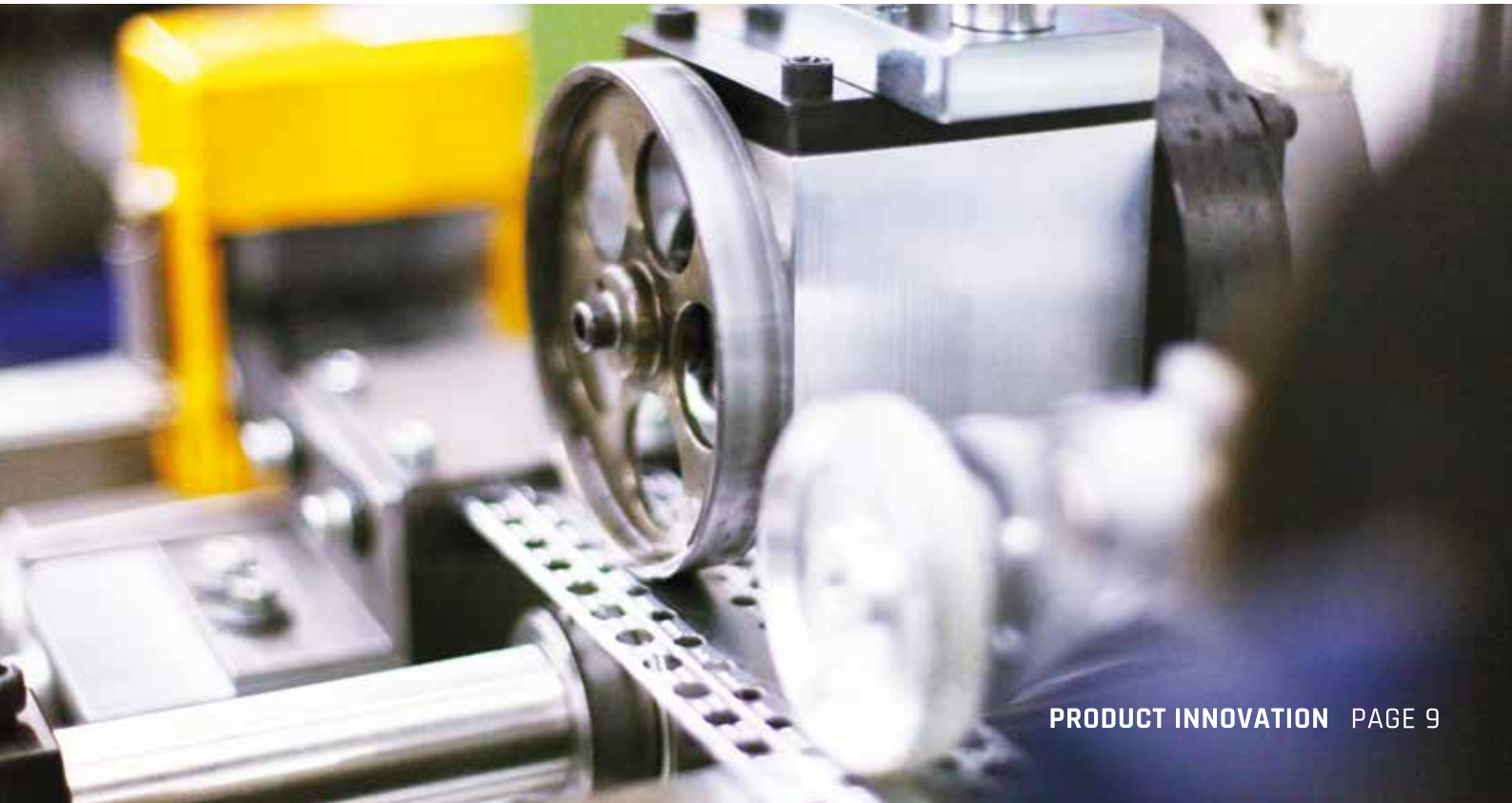

# VWS-PURE PRODUCT SERIES

In our sustainable product series, you will find exclusively items made from recycled materials. A significant step towards environmentally conscious construction.



## The VWS-PURE mesh corner bead: A step towards a green future

Our VWS-PURE mesh corner bead, made from recycled window profiles, combines innovation and sustainability in one product. With a production process that utilizes 100% green energy, we are setting new standards to minimize our carbon footprint. The commitment to sustainability extends to our packaging, which is made from recycled cardboard and paper tape to avoid plastic waste. Our product proves that high quality and active environmental protection can go hand in hand.

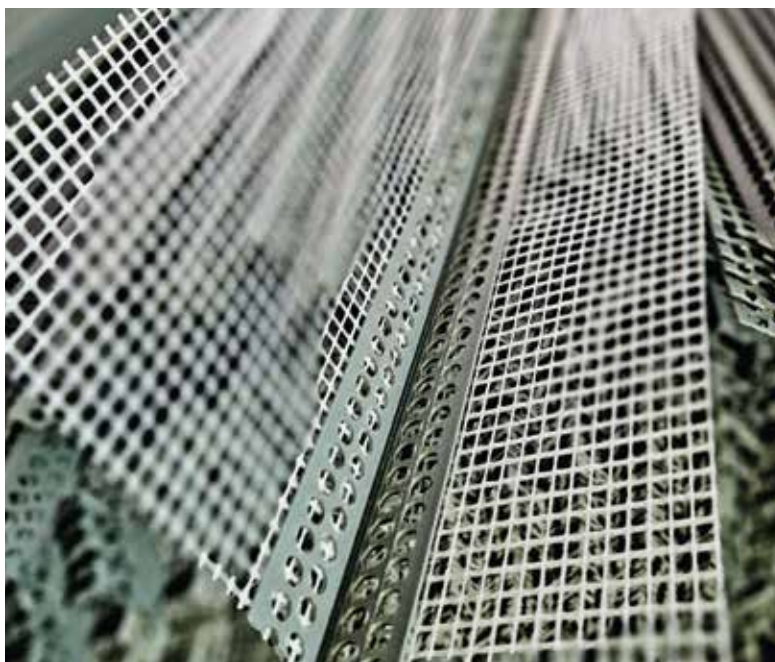

552001

## VWS-PURE fabric corner

The PVC mesh corner bead marks the beginning of our new VWS-PURE series. Soon, you will find additional sustainable products for ETICS, plaster, and drywall.

# REVEAL PROFILES

VWS reveal profiles offer a wide range of applications from interior to exterior plastering, and from drywall to thermal insulation. We ensure quality through internal and external inspections conducted by ift Rosenheim.



## 646900, a profile for all cases: versatile, efficient, and aesthetic

With two rebate edges, it can be used for 6mm and 9mm plaster thickness simultaneously. Whether you are working with a mineral or paste-based plaster system: you only need one profile. With the additional visible lip, you simultaneously achieve a beautiful, clean finish. The new combined reveal profile complements our range of reveal profiles.

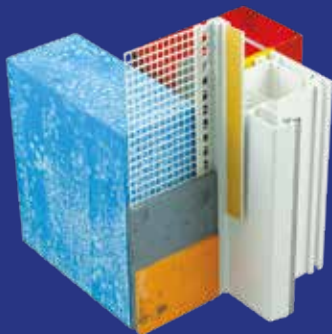
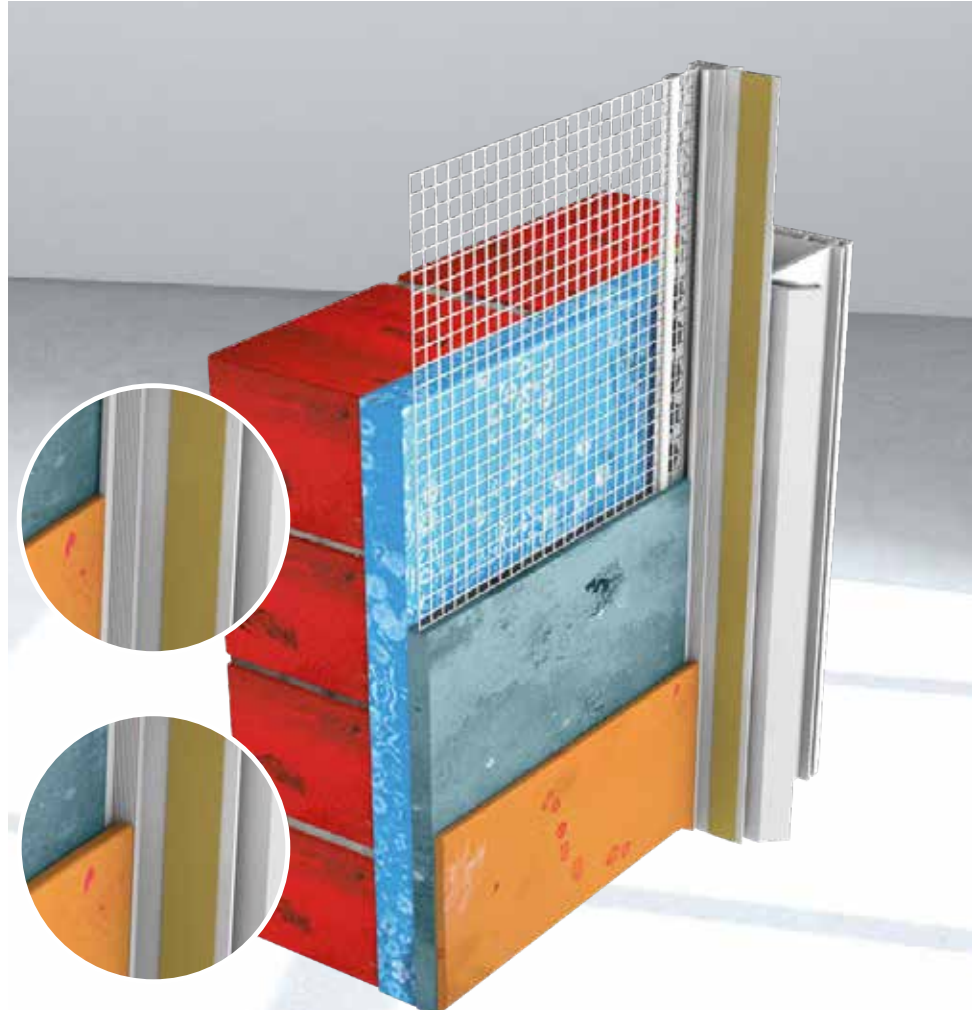

644810

## Reveal profile DYNAMIK

Our patented 3D reveal profile DYNAMIK impresses with high movement absorption in all directions, easy installation, and an affordable price. The technical properties of our DYNAMIK profiles have been determined by an independent testing institute.



“ At VWS, customer satisfaction is the measure of success. With passion and expertise, we are dedicated to surpassing customer expectations. ”

Markus Bartelmuß, VWS Sales Management Export

### Expert advice

You will receive customized solutions and recommendations that meet your specific requirements.

### Always available

Our customer support is always available to address your concerns fast and professionally. Your satisfaction is our highest priority.



Competent employees in both inside and outside service.



Regional contacts available on-site in the shortest possible time.



Continuous availability for our customers.



Partnerships with systems, cooperatives, and associations.



In-house technical department available for inquiries.



Member of the european association of plaster profile manufacturers.

# THE “VWS CAMPUS”

At our “VWS CAMPUS”, you will find numerous expert tips and tricks about our products.

Take advantage of the training opportunities provided by our experts.



## TOPIC 1 DRYWALL PROFILES

If you want more than just simply erecting straight drywall walls, you cannot overlook our PVC profiles. Whether it is curves, expansion or shadow joints, or finishes, metal profiles quickly reach their limits here. Our specialists will show you what is possible with our high-quality PVC profiles.

## TOPIC 2 REVEAL PROFILES

Here, you will learn everything about the properties and applications of reveal profiles in plaster, drywall, and external thermal insulation systems (ETICS). With a focus on the renovation sector, our experts impart knowledge about an essential range of products.

## TOPIC 3 PLASTER PROFILES

How can I avoid rust problems, and what can PVC profiles do better than metal profiles? That's the focus of this training session for your employees and customers. Easier to work with, secure in processing, and applicable for all uses, these are our PVC plaster profiles.

Interested in a professional product training?

If you are interested in training, please register using the QR code below. We look forward to seeing you!



# LOGISTICS: GLOBALLY OPTIMIZED NETWORK

## VWS for seamless operations

The following core optimizations are part of our strategy to ensure efficient and sustainable logistics for our customers:

### Just-in-time deliveries

We rely on precise deliveries to avoid storage costs and bottlenecks.

### Efficient route planning

Precise route planning minimizes transportation distances, reduces costs, and cuts emissions.

### Digitalisation

The use of technology enables precise real-time monitoring and optimization of the supply chain.

### Inventory management

Optimized inventory management enables faster order processing and minimizes warehouse costs.



### Network

Globally optimized and reliable logistics network.



### Delivery date

Orders for stock items placed by 10 am leave our premises the same day.



### Warehouse

Over 650 different profiles permanently in stock.



### Direct

Deliveries to your customers or to the construction site are easily managed.

## By optimizing delivery routes



-100

Tons of CO<sub>2</sub> emissions saved per year



-2000

Less truck kilometers daily

# SOCIAL RESPONSIBILITY

Social responsibility is ingrained in our corporate culture. We actively advocate for diversity and social cohesion. Firmly believing that companies bear a social responsibility, we contribute daily by supporting institutions and associations.



✓ **We support**  
workshops for the blind and other social institutions.



✓ **We sign**  
The Diversity Charter.



✓ **We support**  
numerous local and national associations for years.



✓ **We save**  
26 jobs at Diakonie Reutlingen.



Alternative to Alu

**111200**  
corner profile PERFEKT PVC  
dimensions 24 × 24 mm



**111400**  
round arch profile GENIUS  
dimensions 24 × 24 mm



Alternative to Alu

**111300**  
Lichtenstein profile PERFEKT PVC  
dimensions 14 × 23 mm



**156800**  
Lichtenstein profile PERFEKT  
round arch PVC  
dimensions 14 x 23 mm



**150200**  
edging profile L- shape PVC  
dimensions 12,5 mm



**160200**  
reveal profile L- shape  
PVC self-adhesive  
plasterboard 12.5 mm



**153300**  
movement joint profile  
drywall construction PVC  
dimensions 48 mm



**156600**  
end profile  
PVC with pull-out cover strip  
dimensions 30 × 12.5 mm



**200600**  
depth gauge profile PVC  
10 mm render  
dimensions 36 × 10 mm



**330700**  
angle bead  
PVC White / 14 mm render  
dimensions 40 × 40 mm



**343200**  
PVC D. PRO bellcast bead  
white 10 mm render  
dimensions 10 × 38 mm



**341000**  
M PVC angle bead  
white 10 mm render  
dimensions 40 × 40 mm



1 profile - 2 renders

**646950**  
PVC combi reveal profile with lip  
6 and 9 mm render

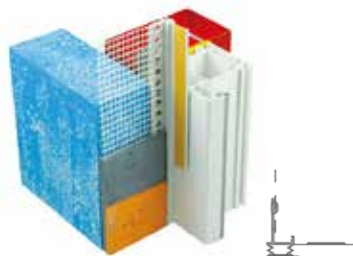

**644600**  
accordion PVC reveal profile  
with mesh for 9 mm render

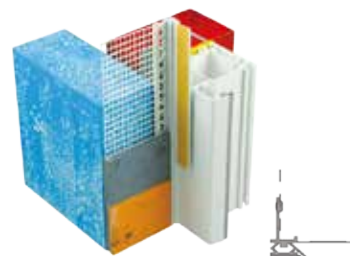

**644810**  
reveal profile DYNAMIK PVC  
with mesh / dimensions 9 mm

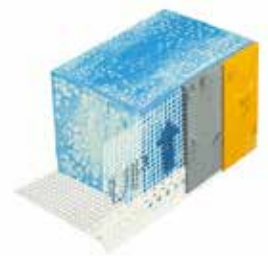

**648501**  
dripnose bead PVC exclusive with mesh  
5 mm render dimensions 10 × 10 cm white



**420200-422600**  
PVC starter track Premium  
dimensions 40 - 240 mm



**630200**  
horizontal movement joint  
profile 5 mm render



**640000**  
Attika PVC end profile with  
mesh 5 mm render

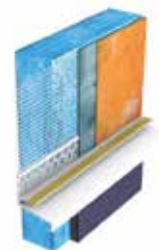

**640100**  
transition profile for ETICS  
on ceramics PVC with mesh

